

Parasoleil

Screen Design Guide

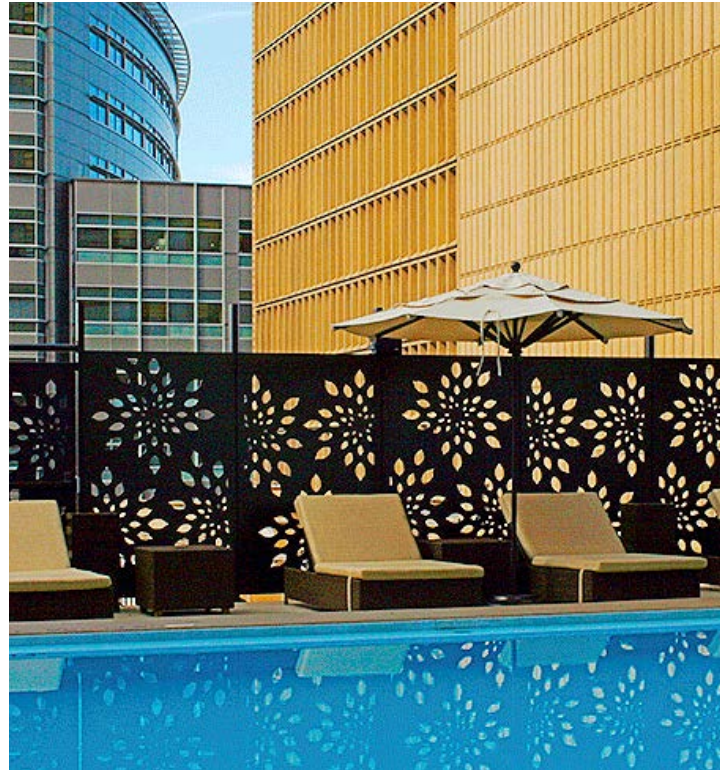



About Parasoleil

Precision cut, hand-finished artisan architectural panels

Parasoleil designs and manufactures an exceptional line of laser-cut architectural metal panels with unique patterns that offer a profoundly artistic aesthetic to any space. Engineered to withstand the elements and manufactured in the United States, these decorative panels provide a functional and durable design that is warranted to last. Parasoleil's project guidance, proprietary hardware and installation system, production dependability, and beautiful powder coats ensure your project's vision comes to life in a memorable and lasting way.

Contact us to learn more

6510 W. 91st Avenue, Suite 100
Westminster, CO 80031
Phone | (303) 327-9997
Email | hello@parasoleil.com
parasoleil.com

 /ParasoleilUSA
 /Parasoleil
 /ParasoleilUSA

Parasoleil

All Parasoleil patterns are protected under copyright law. Copying, modifying, or any unauthorized use of these patterns is strictly prohibited.

Assembly & System Options

INSET MOUNT

Parasoleil Bracket Inset (PBI) Series

Best Use:

Suspend panels between posts

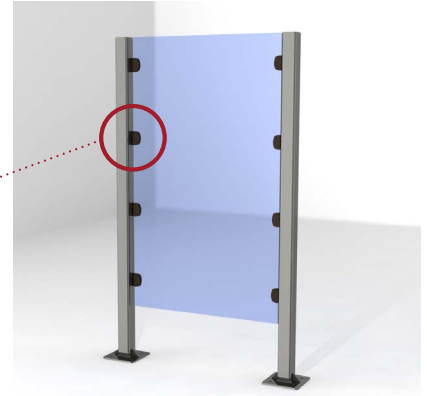
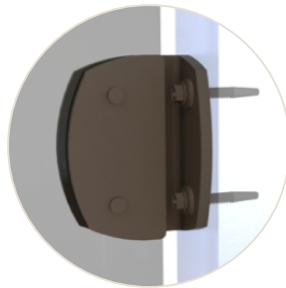

FLAT MOUNT

Parasoleil Flat (PFL) Series

Best Use:

Face mount with maximum field tolerance

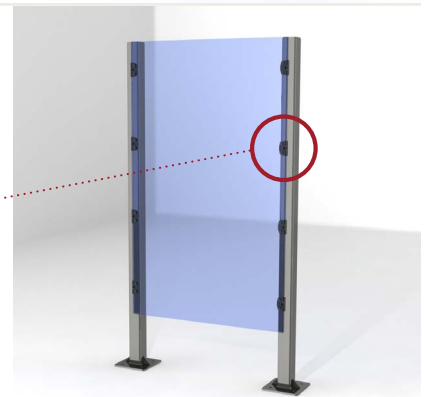
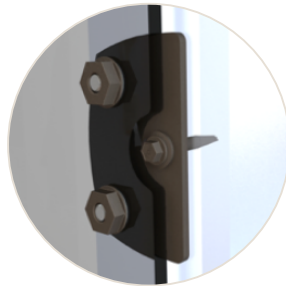

DIRECT MOUNT

Parasoleil Direct Hex (PDH) Series

Best Use:

Face mount standard screws

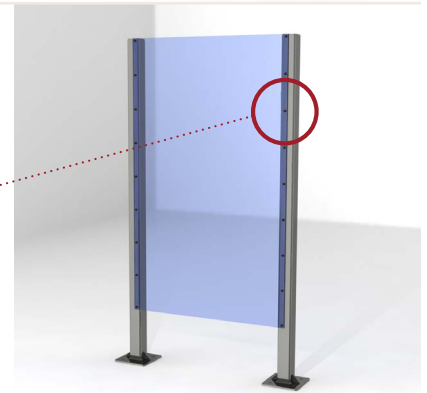
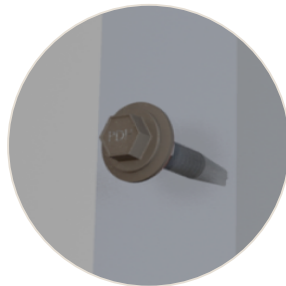

STAND OFF

Parasoleil Stand Off (PSO) Series

Best Use:

Stand off mount with maximum field tolerance

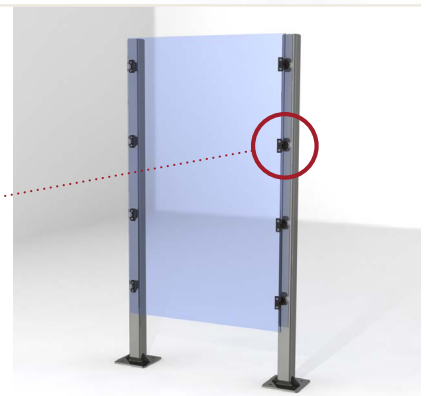

Post Options

ECLIPSE SERIES™

Engineered for rooftops and high wind conditions with bolt-through baseplates and welded connections.

AVAILABLE IN ALUMINUM OR STEEL



EQUINOX SERIES™

Ground-level applications with low or no load requirements. Ideal for landscape and freestanding conditions.

AVAILABLE IN ALUMINUM OR STEEL



CUSTOM ENGINEERED

For unique project requirements, extreme weather conditions or/and challenging fastening scenarios.



POST FINISHES

All posts are prepped with a zinc primer and UV stable exterior grade powdercoat finish.

SELECT FROM PARASOLEIL FRAME AND HARDWARE FINISHES



Screen Steel Post Assembly Details

Screen Front View

Scale 1:24

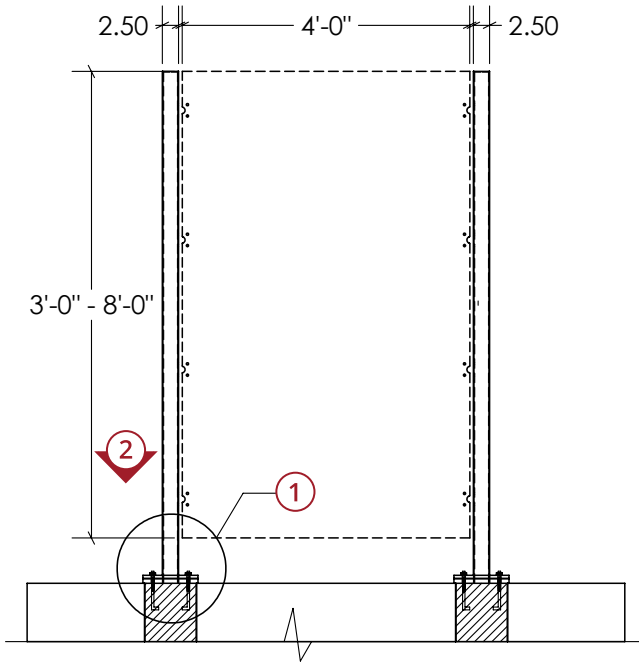

STEEL POST SPECIFICATIONS

- 2" x 2" x 3/16" A36 steel
- Zinc primer for maximum adhesion and corrosion resistance

STEEL BOLTING PLATE SPECIFICATIONS

- 8" x 8" x 3/16" A36 steel plate with 1/2" Diameter anchor bolt holes
- Continuous weld to post

CONCRETE FOOTING ASSEMBLY SPECIFICATIONS

- QTY (4): 3/8" steel anchor bolts with 10" minimum embed
- 12" Diameter x 30" Deep minimum concrete footing.

ENGINEERING SPECIFICATIONS

- Maximum height: 8'-0"

NOTE: posts, foundation, and anchor bolts provided by other suppliers

Contact manufacturer for high wind conditions and specifications.

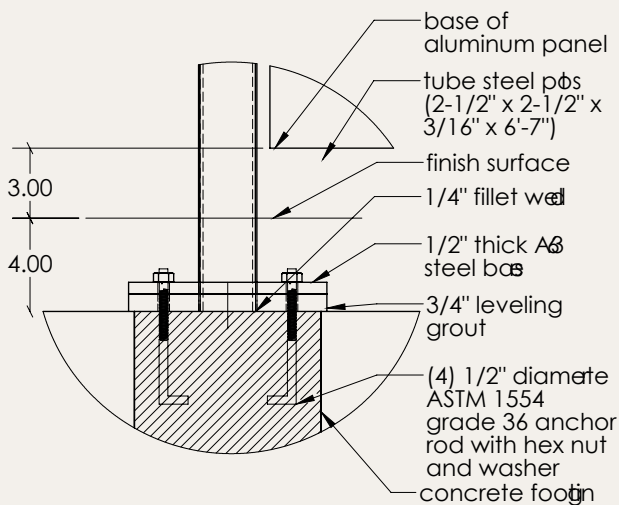

1 Screen Post Base Section
Detail – Scale 1:6

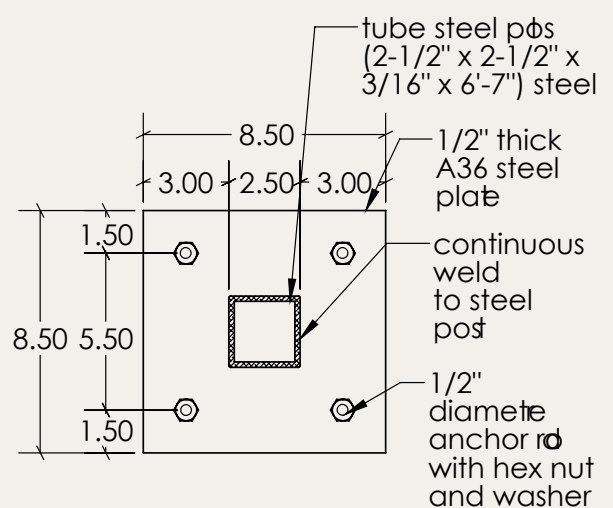

2 Screen Post Base Detail
Scale 1:6

PBI Series Details

Bracket Inset System | Front View

Scale 1:24

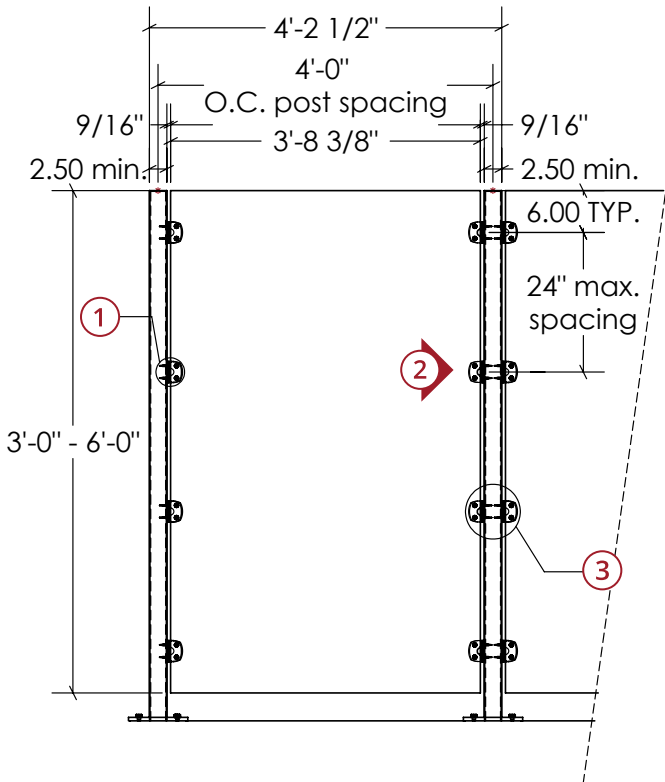

ALUMINUM PANEL SPECIFICATIONS

- Aluminum Alloy: 5052-H32 Series
- Fire Rating: Non Combustible
- Tensile Yield Strength: 28,000 PSI
- Shear Strength: 20,000 PSI
- Melting Point: 1,200°F
- Solid panel weight*:
 - 1/16" thick – 0.9 lb/sf
 - 1/8" thick – 1.8 lbs/sf
 - 3/16" thick – 2.6 lb/sf
 - 1/4" thick – 3.5 lbs/sf

PARASOLEIL BRACKET INSET (PBI) SPECIFICATIONS

- 3/16" A36 steel plate
- Stainless steel flush mount 1/2" -20 x 1/2" long studs
- Stainless steel barrel nuts with EPDM washers
- Graftone AAMA 2604 compliant powder coat hardware finish
- Zinc primer for maximum adhesion and corrosion resistance

PARASOLEIL DIRECT HEX (PDH) SELF DRILLING SCREW SPECIFICATIONS

- #12-24 x 1-1/2" with #3 drill tip
- 5/16" hex head and driver included
- Carbon steel with dual corrosion resistant coatings
- Bonded neoprene washer
- Salt spray resistance: 1,000 hours per ASTM B117
- Pull-out value: 2,100 lbs when installed in 3/16" steel

NOTE: posts, foundation, and anchor bolts provided by other suppliers

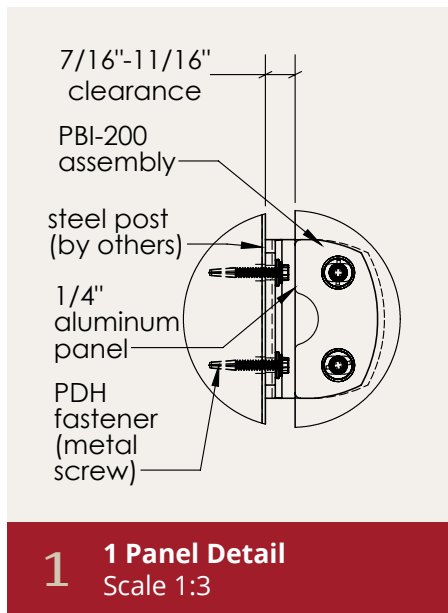

1 1 Panel Detail
Scale 1:3

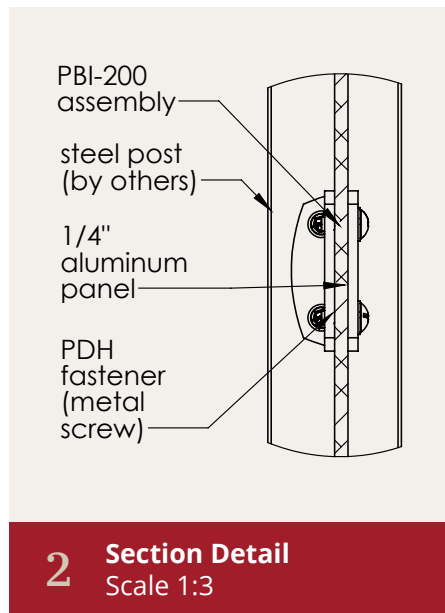

2 Section Detail
Scale 1:3

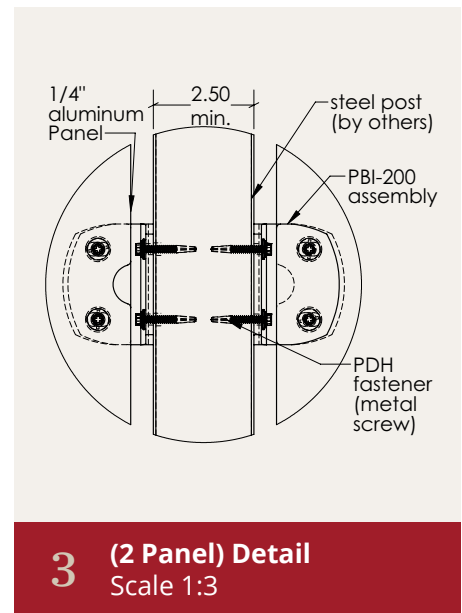

3 (2 Panel) Detail
Scale 1:3

PBI Series Installation Guidance

PARTS LISTING:



PBL-200
Base



PBL-200
Mounting Plate



PDS SCREWS
Bracket anchor



BARREL NUTS



PDH SCREWS
For installing on
metal structures
- OR -



PDW SCREWS
For installing on
wood structures



**NEOPRENE
WASHERS**

TOOLS NEEDED

- Measuring tape
- Marking pencil
- Conventional drill with 7/16" driver
- Phillips screwdriver

PREPARATION

Confirm support post spacing and configuration consistency with panel sizes.

FIELD NOTES

Contact Parasoleil for installation questions especially for high wind load conditions. See Parasoleil's warranty document for coverage. Field drilling Parasoleil panels is allowed under warranty, however field cutting panels is not recommended and will void manufacturer's warranty.

If an alternate panel size is needed, contact Parasoleil for assistance.

Figure 1: Typical PBI Hardware Installation

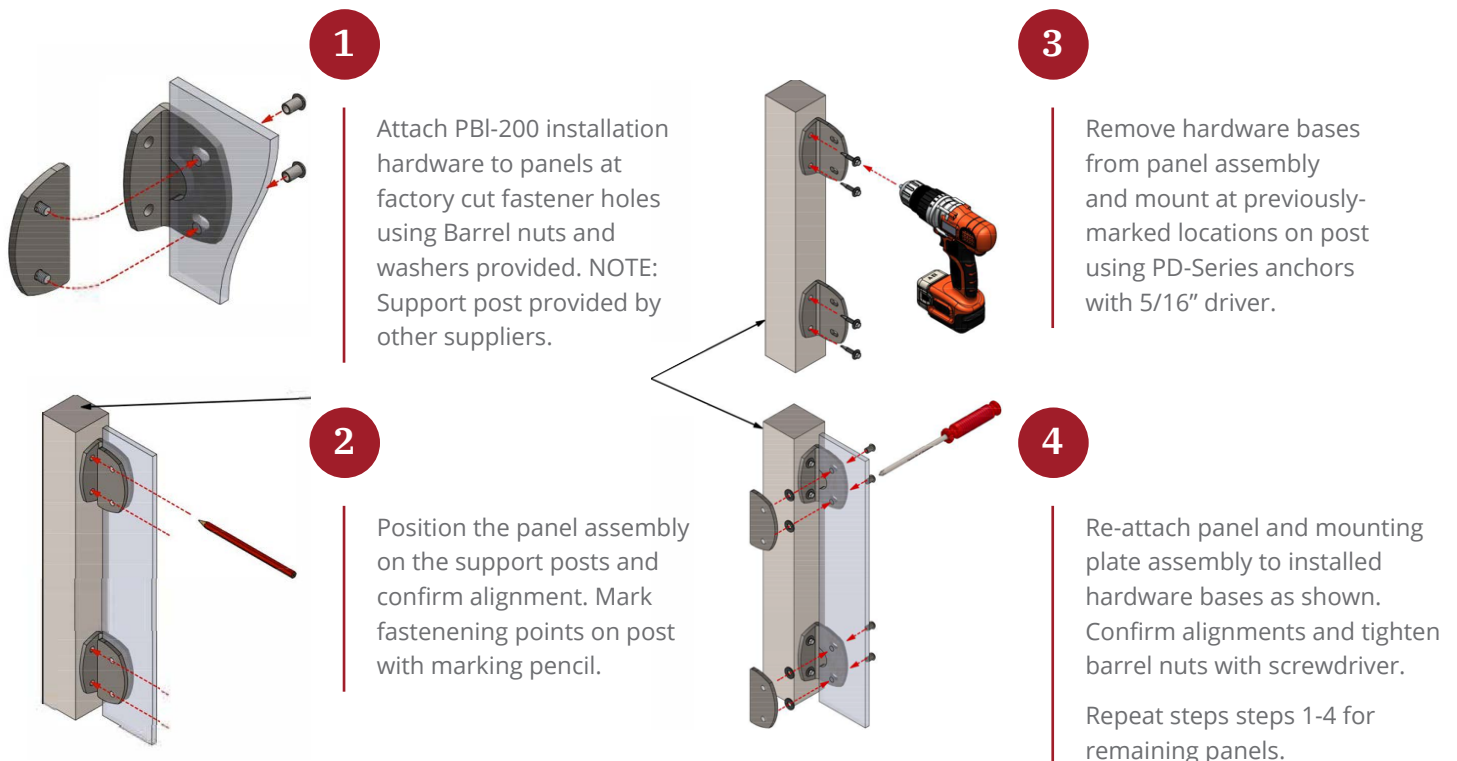

PFL Series Details

Flat Mount System | Front View

Scale 1:24

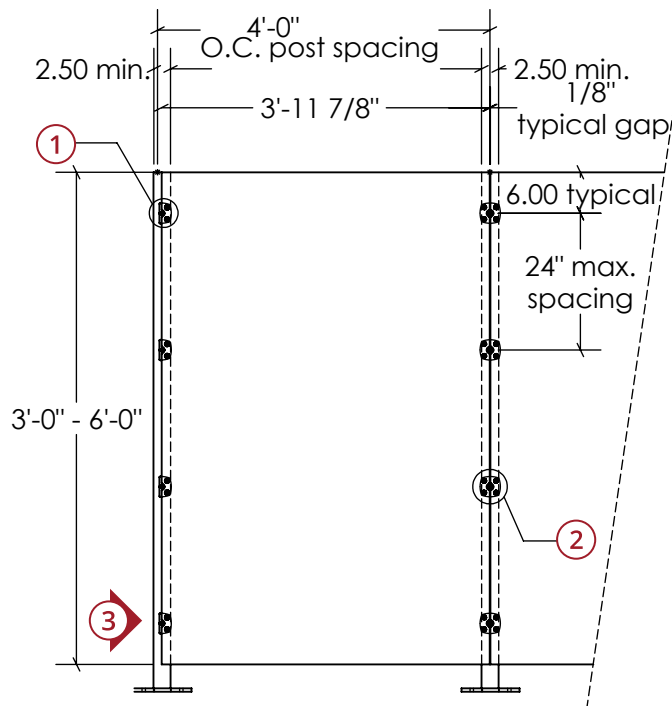

PARASOLEIL FLAT (PFL) SPECIFICATIONS

- 1/8" A36 steel plate
- Stainless steel flat mount 1/4" -20 x 1/2" long studs
- 70 in/lb max nut tightening torque
- Stainless steel locking flange hex nuts with EPDM washer
- Stainless steel center anchor with bonded neoprene washer

PARASOLEIL DIRECT HEX (PDH) SELF DRILLING SCREW SPECIFICATIONS

- #12-24 x 1-1/2" with #3 drill tip
- 5/16" hex head and driver included
- Carbon steel with dual corrosion resistant coatings
- Bonded neoprene washer
- Salt spray resistance: 1,000 hours per ASTM B117
- Pull-out value: 2,100 lbs when installed in 3/16" steel

NOTE: posts, foundation, and anchor bolts provided by other suppliers

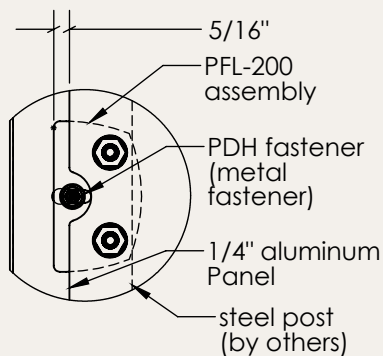

1 (1 Panel) Detail
Scale 1:3

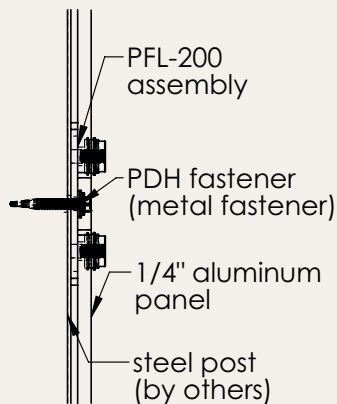

2 Section Detail
Scale 1:3

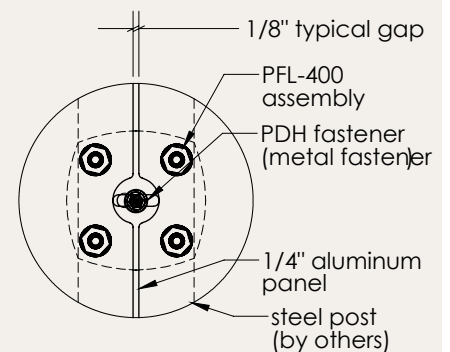

3 (2 Panel) Detail
Scale 1:3

PFL Series Installation Guidance

PARTS LISTING:



PFL-200
Perimeter of
panel array



PDH SCREWS
For installing on
metal structures

- OR -



PFL-400
Interior at panel
seams



PDW SCREWS
For installing on
wood structures



PDS SCREWS
Bracket anchor



**NEOPRENE
WASHERS**

- OR -



LOCKNUTS
At each bracket
stud



CAPNUTS
At each bracket
stud

TOOLS NEEDED

- Measuring tape
- Marking pencil
- Conventional drill with 5/16" and 7/16" drivers

PREPARATION

Confirm support post spacing is consistent with panel sizes.

FIELD NOTES

Contact Parasoleil for installation questions, especially for high wind load conditions.

See Parasoleil's warranty document for warranty coverage.

Field drilling Parasoleil panels is allowed under warranty, however field cutting panels is not recommended and will void manufacturer's warranty.

If an alternate panel size is needed, contact Parasoleil for assistance.

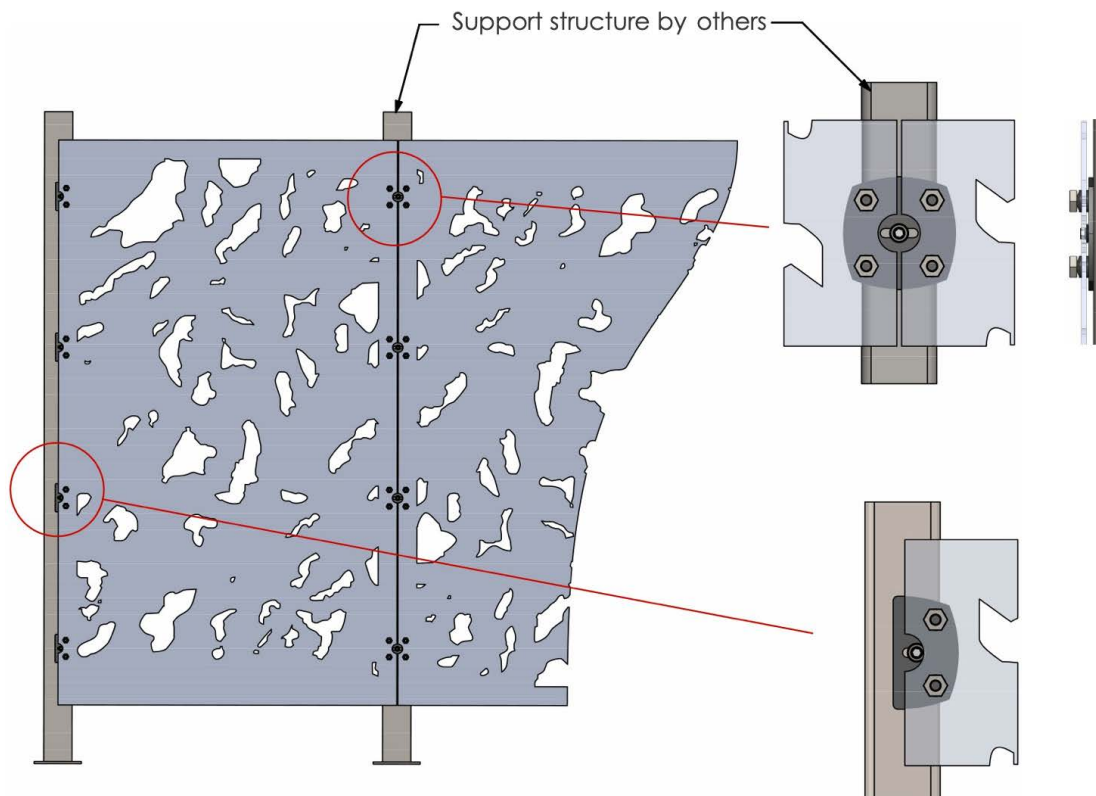

Direct Mount Details

Direct Mount System | Front View Scale 1:24

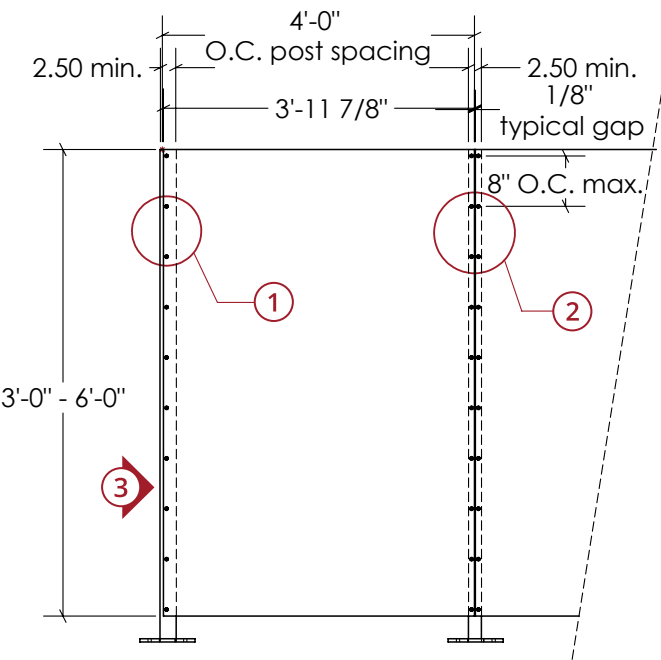

PARASOLEIL DIRECT HEX (PDH) SELF DRILLING SCREW SPECIFICATIONS

- #12-24 x 1-1/2" with #3 drill tip
- 5/16" hex head and driver included
- Carbon steel with dual corrosion resistant coatings
- Bonded neoprene washer
- Salt spray resistance: 1,000 hours per ASTM B117
- Pull-out value: 2,100 lbs when installed in 3/16" steel

NOTE: posts, foundation, and anchor bolts provided by other suppliers

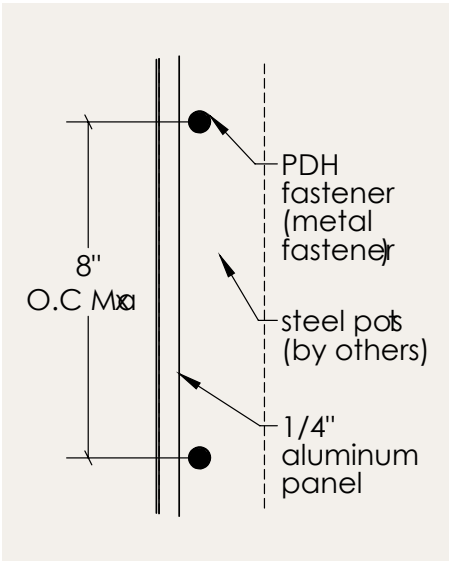

1 (1 Panel) Detail
Scale 1:4

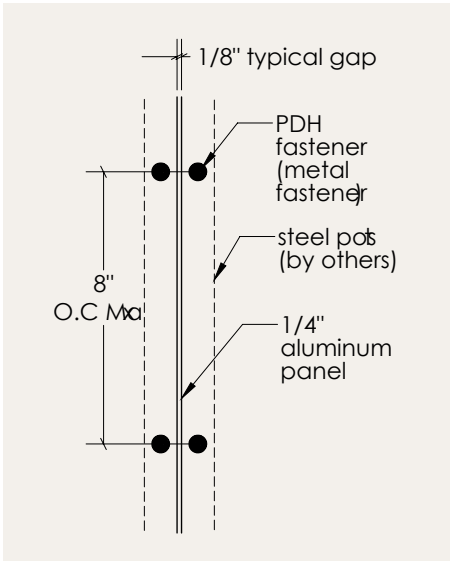

2 (2 Panel) Detail
Scale 1:4

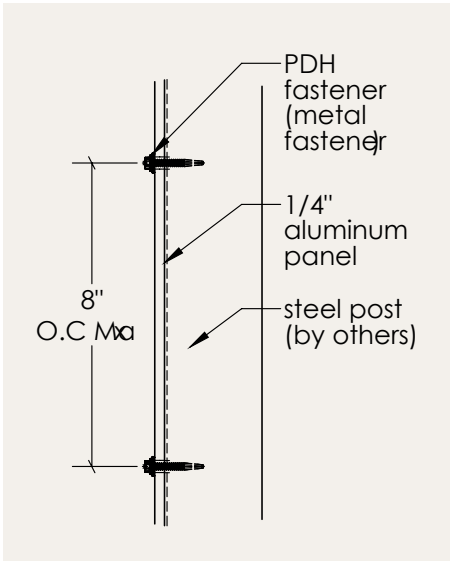

3 Section Detail
Scale 1:4

PSO Series Details

Stand Off System | Front View

Scale 1:24

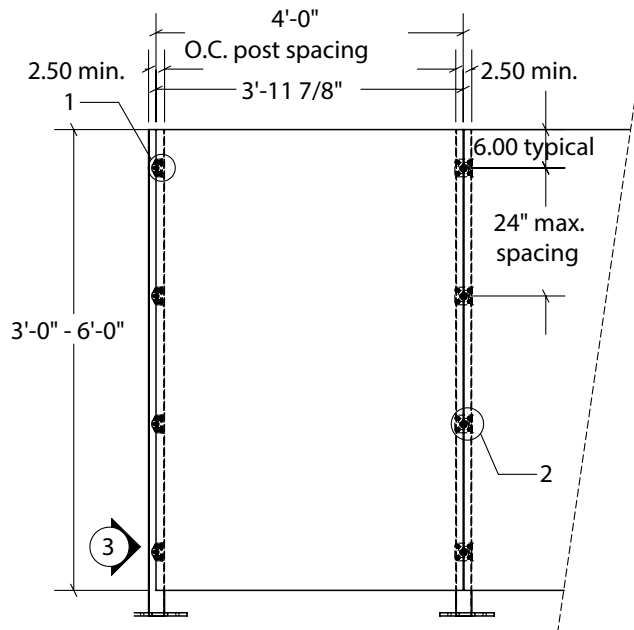

PARASOLEIL STAND OFF (PSO) SPECIFICATIONS

- 1/8" A36 steel plate
- Panels stand-off 2" from substrate
- Parasoleil Standard Graftone Powdercoat Finish – AAMA 2604 compliant
- Zinc Primer for maximum adhesion and corrosion resistance
- Floating self-clinching nut: .250 - 20 thread count
- Carbon steel, zinc plated
- 400 lb push out force

PARASOLEIL DIRECT HEX (PDH) SELF DRILLING SCREW SPECIFICATIONS

- #12-24 x 1-1/2" with #3 drill tip
- 5/16" hex head and driver included
- Carbon steel with dual corrosion resistant coatings
- Bonded neoprene washer
- Salt spray resistance: 1,000 hours per ASTM B117
- Pull-out value: 2,100 lbs when installed in 3/16" steel

NOTE: posts, foundation, and anchor bolts provided by other suppliers

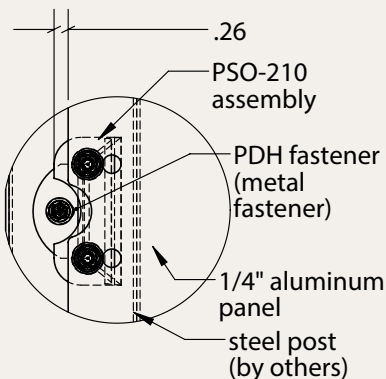

1 (1 Panel) Detail
Scale 1:3

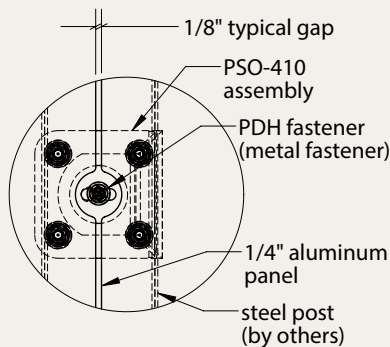

2 (2 Panels) Detail
Scale 1:3

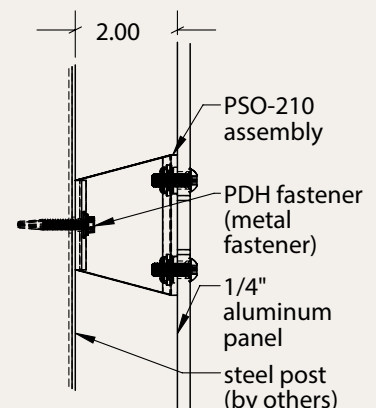

3 Section Detail
Scale 1:3

PSO X10 Series Installation Guidance

PARTS LISTING:



PSO-110
Corners of panel array



PSO-210
Perimeter of panel array



PSO-410
Interior at panel seams



**TAMPER-RESISTANT
& FLAT HEAD SCREW**
Bracket center anchor

TOOLS NEEDED

- Measuring tape
- Marking pencil
- Conventional drill with 5/16" and 7/16" drivers

PREPARATION

Confirm adequate blocking or structure is present within wall at center anchor mounting locations.

FIELD NOTES

Contact Parasoleil for installation questions, especially for high wind or snow load conditions.

See Parasoleil's warranty document for warranty coverage.

Field drilling Parasoleil panels is allowed under warranty, however, field cutting panels is not recommended and will void manufacturer's warranty. If an alternate panel size is needed, contact Parasoleil for assistance.

Figure 1: Typical Hardware Layout

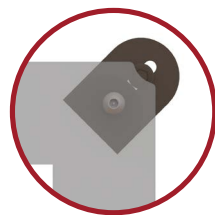

PSO-110
Installation
Hardware

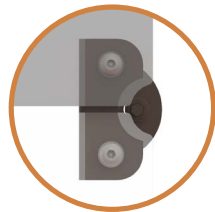

PSO-210
Installation
Hardware

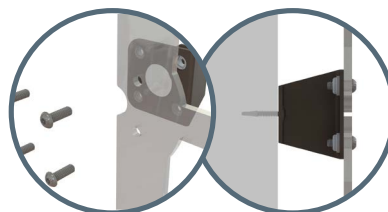

PSO-410
Installation
Hardware

PSO X10 Series Installation Guidance *(continued)*

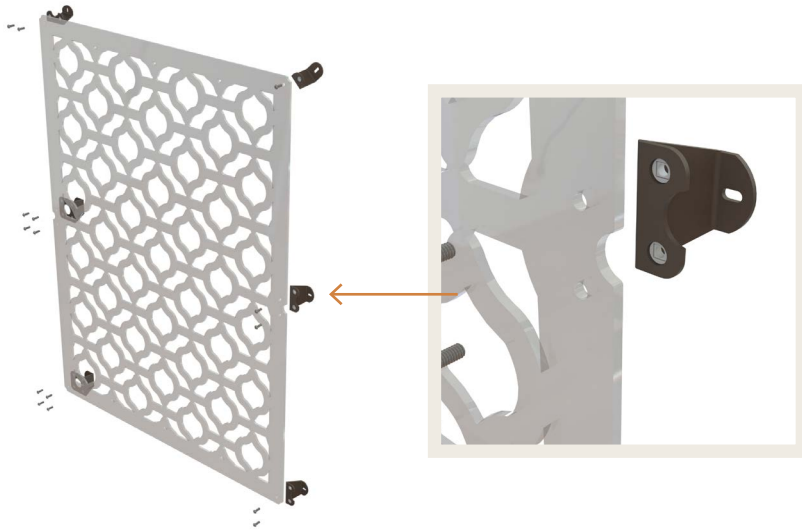

1

Beginning with the first panel as shown in **Figure 1**, attach PSO-Series hardware to panels with provided fastener.

2

Position the first panel assembly to the post and confirm location, alignment and adequate mounting structure or blocking at mounting locations. Install assembly with PSO center anchors using 5/16" driver.



3

Repeat Step 1 for the next panel and position on post using shared hardware points on Panel 1 as shown.

Confirm alignments and blocking and install second assembly using PSO center anchors with 5/16" driver.

Repeat steps 1-3 for remaining panels.



Spec Guidance & Engineering

PANEL SPANS

Recommended panel thicknesses for certain widths using our Panel Thickness Callibrator to find the more appropriate dimensions.

PANEL SPAN / THICKNESS EXAMPLE TABLE

THICKNESS	WEIGHT*	SPAN BETWEEN SUPPORTS**
1/8"	1.8 lbs/sf	24-36"
3/16"	2.6 lbs/sf	30-48"
1/4"	3.5 lbs/sf	36-52"

* Subtract pattern open % for final weight.
** General guideline only; please ask Parasoleil for project specific design assistance.



POST SPECS

There is a difference between steel and aluminum posts, and choosing plate dimensions for your project needs. Wall thickness must be considered for both structural rigidity and ease of installation.

Recommended footers and base location

Design Pressure	14 PSF
Panel Dimensions	3'x8'

Post Size (in)	Post Wall Thickness (in)			
	0.06"	0.125"	0.1875"	0.250"
2" x 2"	FAIL	FAIL	FAIL	FAIL
2.5" x 2.5"	FAIL	FAIL	FAIL	FAIL
3" x 3"	FAIL	FAIL	PASS	PASS
3" x 4"	FAIL	PASS	PASS	PASS
4" x 4"	PASS	PASS	PASS	PASS

SPECIFICATION PROCESS

1. Determining exact details to meet project design load requirements.
2. Full specifiable screen systems for ease of procurement and installation by one substrate.
3. Proprietary patterns and hardware systems for confidence in locking the specification.



PBI Series Installation Hardware

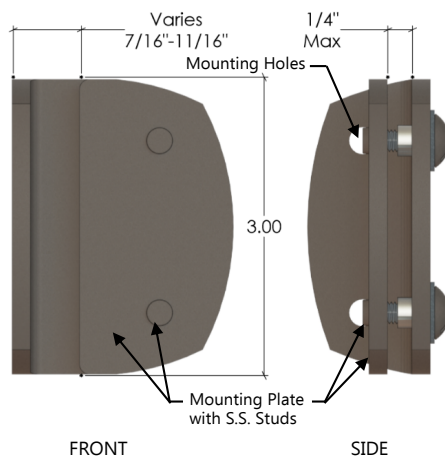
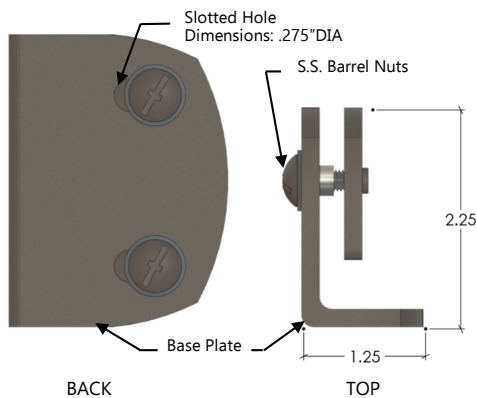
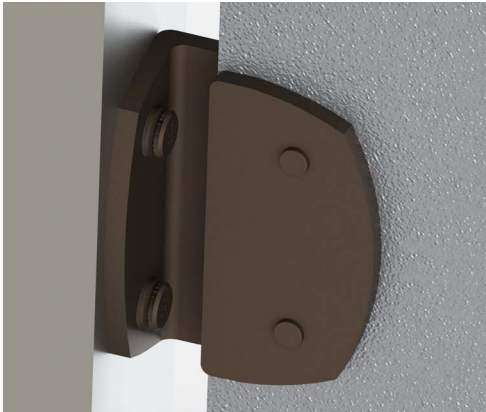

Parasoleil's standard hardware combines beauty, utility, and durability to offer an elegant installation solution for a wide range of projects. It is an expressed element that standardizes the installation process, increases corrosion-resistance and enhances the overall aesthetic of the installation.

BENEFITS & FEATURES

- Universal design for attachment of aluminum panels up to 1/4" thick
- Universal factory cut fastener holes ensure consistent fastening point spacing and easy installation
- Adjustable for inconsistent field conditions
- Attaches to steel or wood with a minimum of 2" wide attachment surface

SPECIFICATIONS

- 3/16" A36 steel plate
- Stainless steel flush mount 1/2" -20 x 1/2" long studs
- Stainless steel barrel nuts with EPDM washers

STRUCTURAL RECOMMENDATIONS

- 24" on center max. recommended bracket spacing along panel edges
- Contact Parasoleil for installation guidelines
- Contact local building department for the most accurate building code requirements for railing and guardrails

FINISHES

- Three AAMA 2604 compliant powdercoat hardware finishes available
- Zinc primer for maximum adhesion and corrosion resistance



QUESTIONS?

Contact Parasoleil for complete specifications, installation requirements and warranty coverage.

PBI Series Installation Hardware



Parasoleil's standard hardware combines beauty, utility, and durability to offer an elegant installation solution for a wide range of projects. It is an expressed element that standardizes the installation process, increases corrosion-resistance and enhances the overall aesthetic of the installation.

BENEFITS & FEATURES

- Universal design for attachment of aluminum panels up to 1/4" thick (US Patent Pending)
- Easy three-step installation
- Universal factory cut fastener holes ensure consistent fastening point and panel spacing
- Adjustable for inconsistent field conditions
- Minimizes moisture and debris collection between panel and support structure
- Attaches to steel or wood support structure
- Ideal for attaching to 1 narrow steel or wood support structures less than 2" width

SPECIFICATIONS

- 1/8" A36 steel plate
- Stainless steel flush mount 1/4" -20 x 1/2" long studs
- 70 in/lb max nut tightening torque
- Stainless steel locking flange hex nuts with EPDM washer
- Corrosion resistant center anchor with bonded neoprene washer

STRUCTURAL RECOMMENDATIONS

- 24" on center max. recommended bracket spacing along panel edges. Supplemental fasteners are required between hardware locations for high wind or snow load conditions
- Contact local building department for the most accurate snow and wind load information for your area

FINISHES

- Available in Graftone™, Nimbus™, and Raven™ as standard finishes, any other finishes are considered custom
- Zinc primer for maximum adhesion and corrosion resistance

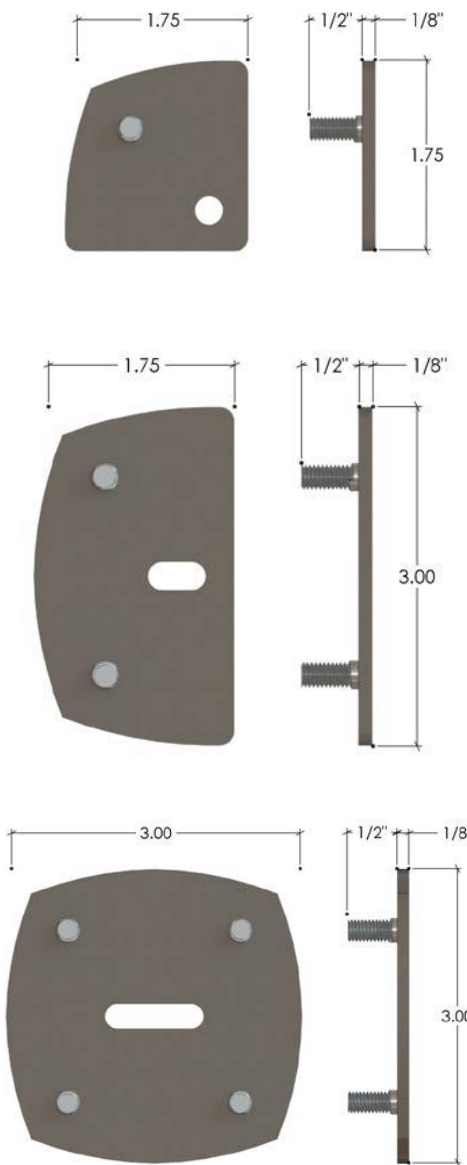

PSO Series Installation Hardware

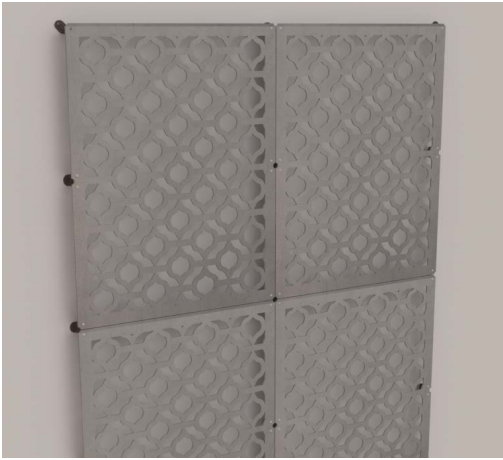

Parasoleil's standard offset hardware combines beauty, utility, and durability to offer an elegant installation solution for a wide range of vertically mounted applications. With subtly expressed the fasteners in a face-mounted assembly, this system standardizes the installation process, increases corrosion-resistant and enhances the overall aesthetic of the installation.

Tamper-resistant fasteners are recommended for high traffic, public areas while the flush mount fastener option is an excellent alternative for zero-profile facemounted applications.

BENEFITS & FEATURES

- Universal design for attachment of aluminum panels up to 1/4" thick (US Patent Pending)
- Easy three-step installation
- Universal factory cut fastener holes in panels ensure consistent fastening point and panel spacing
- Adjustable for inconsistent field conditions
- Attaches to most substrates (steel, concrete, wood, aluminum, masonry)
- Suitable for interior and exterior applications
- Easy removal and replacement as needed

SPECIFICATIONS

- 1/8" A36 steel plate
- Panels stand-off 2" from substrate
- Available in Graftone™, Nimbus™, and Raven™ as standard finishes, any other finishes are considered custom
- Zinc Primer for maximum adhesion and corrosion resistance
- Floating self-clinching nut: .250 - 20 thread count
 - Carbon steel, zinc plated
- 400 lb push out force



PEM® Double Squares registered trademark.

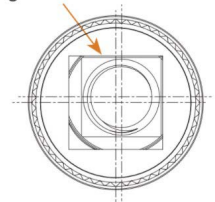

Float - .015"/0.38 mm minimum, in all directions from center, .030"/0.76 mm total.

PSO Series Installation Hardware *(continued)*

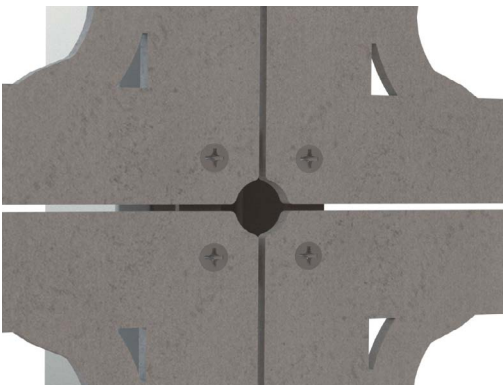

FASTENER OPTIONS

1. Tamper Resistant Button Head 5/32" Hex Head Fastener
 - a. 1/4" – 20 x 3/4" long
 - b. Fastener head to color coordinate with panel powdercoat finish
2. Flat Head Philips screw – Flush Mount
 - a. 1/4" – 20 x 3/4" long – 100° bevel
 - b. Machine drilled bevel for each fastener hole in panel (1/8" minimum panel thickness)
 - c. Fastener head to color coordinate with panel powdercoat finish



STRUCTURAL RECOMMENDATIONS

- 24" on center max. recommended bracket spacing along panel edges
- High wind conditions require additional support and/or thicker brackets
- Contact local building department for the most accurate wind load information for your area

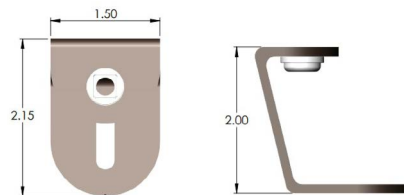

PSO-110

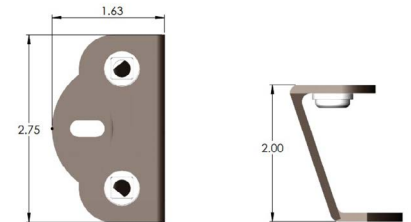

PSO-210

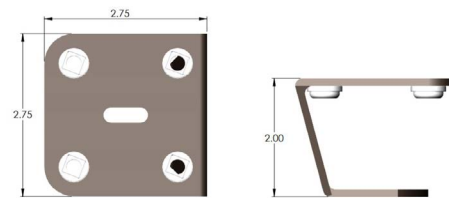

PSO-410

QUESTIONS?

Contact Parasoleil for complete specifications, installation requirements and warranty coverage.

Direct Mount Fastener Hardware

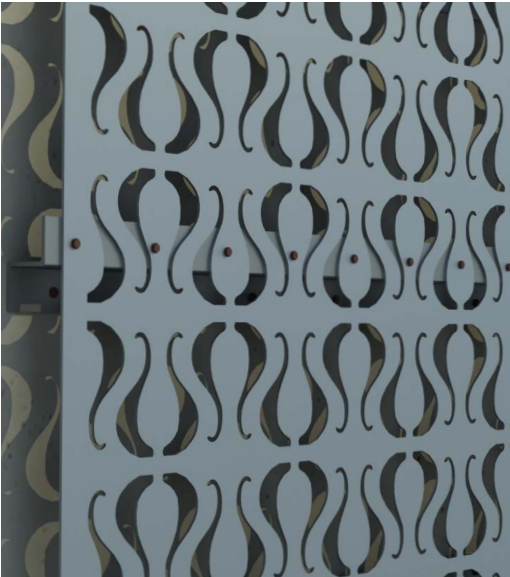

Parasoleil offers a number of different screws that are hand selected to fit your project needs. All screws come pre-painted in the color that best coordinates with the panel powdercoat finish. Drivers are included in all screw orders.



PDH



PDS



PDW

SCREW MATERIAL	Carbon Steel	Stainless Steel	Stainless Steel
SCREW SPEC	#12 24 x 1"	#12 14 x 1-1/4"	#10 12 x 2-3/8"
SUBSTRUCTURE MATERIAL	up to 3/8" structural steel	up to 1/8" light gage steel	Wood
SCREW TIP	#3 Drill Tip Self Tapping	#3 Drill Tip Self Tapping	Thread Forming
DRIVE	5/16" Hex	Proprietary Driver	T20 Torx
PULL-OUT VALUE	1,678 lbs	1,282 lbs	520 lbs
PAINTED HEAD	Yes	Yes	Yes

QUESTIONS?

Contact Parasoleil for complete specifications, installation requirements and warranty coverage.

PDH Fastener Hardware

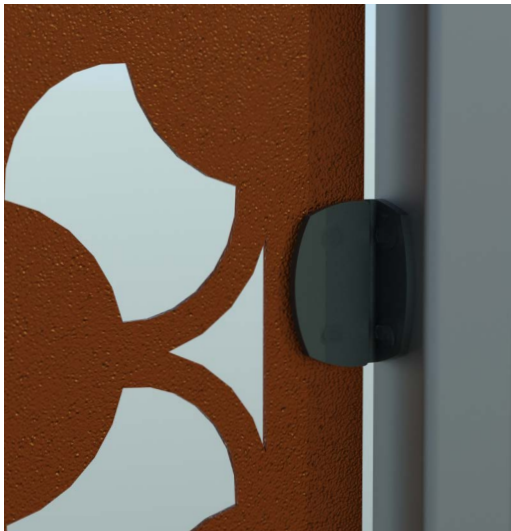

SELF DRILLING SCREWS FOR STEEL SUPPORTS

Parasoleil aluminum panels may be installed directly onto structural steel supports using our PDH drill screw. Factory cut fastener holes in panels are available upon request. For steel thickness no more than 3/8", pilot holes are recommended.

PDH DRILL SCREWS

For installing Parasoleil aluminum panels and hardware to structural steel **up to 3/8" thick** and include neoprene washer for maximum corrosion protection.

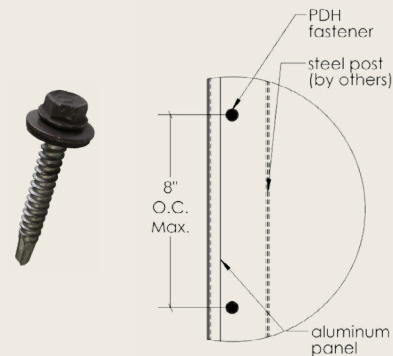

INSTALLATION GUIDELINES

- Allow for 1/8" gap between panels for expansion and contraction of the metal due to temperature variations
- Fastener spacing 8" on center maximum at all support locations for engineered applications
- Adjust torque settings as needed to avoid overtightening which may cause fastener twist offs

PDH DRILL SCREWS SPECIFICATIONS

- #12 - 24 x 1" with #3 drill tip
- 5/16" hex head & driver included
- Carbon steel with dual corrosion resistant coatings
- Bonded neoprene washer
- Salt spray resistance: 1,000 hours per ASTM B117
- Pull-out value: 1,678 lbs when installed in 1/8" substructure

QUESTIONS?

Contact Parasoleil for complete specifications, installation requirements and warranty coverage.

PDS Fastener Hardware

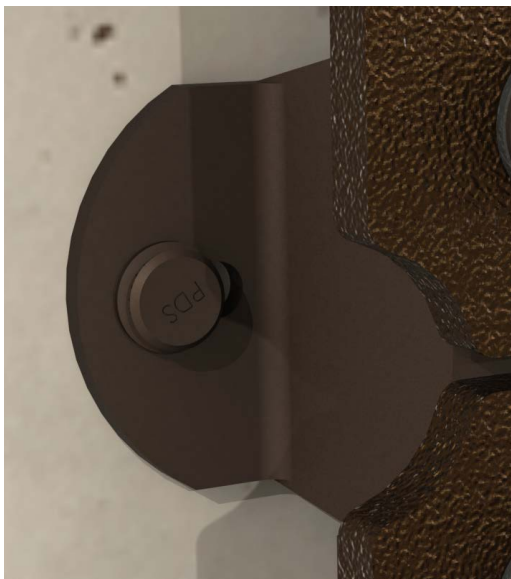
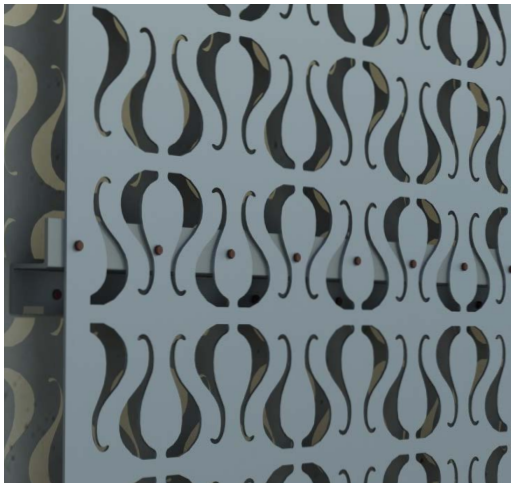

SELF DRILLING SCREWS FOR STEEL SUPPORTS

Parasoleil aluminum panels may be installed directly onto finished light gauge steel supports using our PDS drill screw. Factory cut fastener holes in panels are available upon request. Tamper resistant proprietary head offers a clean aesthetic for a higher level of finish.

PDS DRILL SCREWS

For installing Parasoleil aluminum panels to light gauge steel up to 1/8" thick, or aluminum support structure for design conscious applications and include neoprene washer for maximum corrosion protection.

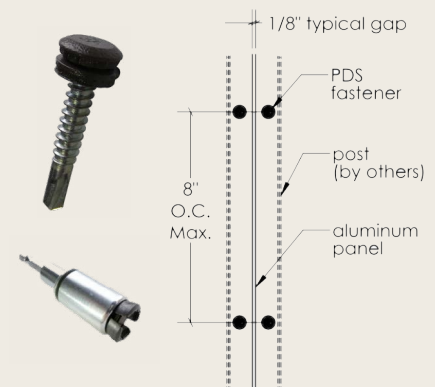

INSTALLATION GUIDELINES

- Allow for 1/8" gap between panels for expansion and contraction of the metal due to temperature variations
- Fastener spacing 8" on center maximum at all support locations for engineered applications
- Adjust torque settings as needed to avoid overtightening which may cause fastener twist offs

PDS DRILL SCREWS SPECIFICATIONS

- #12 - 14 x 1-1/4" with #3 drill tip
- 1/2" Outside Diameter low profile head
- 300 series stainless steel head & shank
- Bonded neoprene washer
- Tamper resistance fastener head with no accessible driver access
- Provided drive socket ensures positive engagement and prevents damage to painted fastener head
- Pull-out value: 1,282 lbs when installed in 1/8" substructure

QUESTIONS?

Contact Parasoleil for complete specifications, installation requirements and warranty coverage.

PDW Fastener Hardware

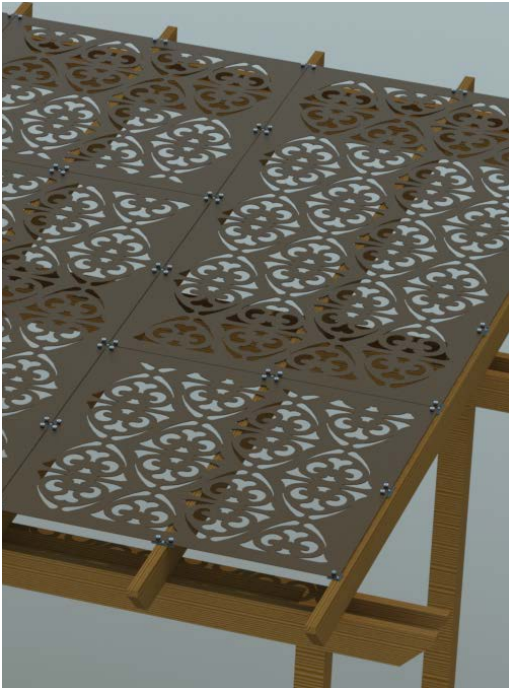

SELF DRILLING SCREWS FOR WOOD SUPPORTS

The PDW fastener has a clean architectural aesthetic for design conscious applications requiring maximum corrosion protection for aluminum panels on wood supports. Aluminum panels require pre-drilled fastener holes.

PDW DRILL SCREWS

For installing Parasoleil aluminum panels wood support structure for design conscious applications and include neoprene washer for maximum corrosion protection.

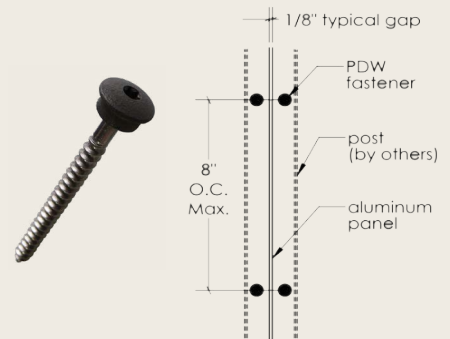

INSTALLATION GUIDELINES

- Allow for 1/8" gap between panels for expansion and contraction of the metal due to temperature variations.
- Fastener spacing 8" on center maximum at all support locations for engineered applications.
- Adjust torque settings as needed to avoid overtightening which may cause fastener twist offs.

SPECIFICATIONS

- #10 - 12 x 2-3/8" long
- 1/2" Outside Diameter low profile T20 Star Head
- 300 series stainless steel head & shank
- Bonded neoprene washer included
- Pull-out value: 520 lbs

QUESTIONS?

Contact Parasoleil for complete specifications, installation requirements and warranty coverage.

Aluminum Panel Material and Thickness



PANEL SPAN / THICKNESS EXAMPLE TABLE

THICKNESS	WEIGHT*	SPAN BETWEEN SUPPORTS**
1/8"	1.8 lbs/sf	24-36"
3/16"	2.6 lbs/sf	30-48"
1/4"	3.5 lbs/sf	36-52"

* Subtract pattern open % for final weight.
** General guideline only, please ask Parasoleil for further design assistance.

Allowable deflection represents the maximum deflection allowed by International Building Code (IBC) L/60.

Notes: Values above are for general reference only and may not be recommended for your specific project requirements.

- Values above are based on:
- Exposure B, Risk Factor IV
 - Lemon Drop as baseline pattern
 - PBI installation hardware

Contact Parasoleil for recommendations for high wind pressure conditions not shown above or for your specific project.

Parasoleil offers decorative laser cut aluminum panels in several standard thicknesses. We offer detailed project specific design assistance to ensure the most appropriate thickness is specified based on the amount of panel.

PANEL THICKNESS SELECTION FACTORS

- Application type
- Panel span between supports
- Project engineering design pressure
- Documented code compliance requirements
- Fastening method

1/8" THICK ALUMINUM PANELS

- Generally recommended span: 24-36"
- Durable plus light weight for ease of installation
- Commonly used for:
 - Residential & commercial shade structures
 - Commercial ceilings
 - Commercial cladding with mid-panel support

3/16" THICK ALUMINUM PANELS

- Generally recommended span: 30-48"
- Good span capability with visual weight for brand conscious eye-level applications and wider clear span over-head applications
- Commonly used for:
 - commercial wider span shade structures
 - Commercial wider span cladding
 - Commercial screens

1/4" THICK ALUMINUM PANELS

- Generally recommended span: 36-52"
- Good span capability with visual weight for brand conscious eye-level applications and wider clear span over-head applications
- Commonly used for:
 - commercial wider span shade structures
 - Commercial wider span cladding
 - Commercial screens

Powdercoat Finishes for Aluminum



Parasoleil's award-winning proprietary powdercoat finishes for aluminum are specifically developed for their versatility, durability, and beauty to match the timeless qualities of our architectural panels.

BENEFITS & FEATURES

- 10-year finish warranty for UV performance and adhesion to base metal
- Quality gloss and color retention
- Finished on both sides for maximum versatility
- UV stable, no VOCs, and exterior grade

PROPRIETARY FINISHES

- **Quality Standards:** Consistent in color and texture, these finishes are versatile.
- **Patinas:** With a varied aesthetic, these finishes have unique markings, tones and qualities based on aged metals.

WARRANTY FOR STANDARD FINISH

All standard finishes are protected by are protected by a 10-year warranty against cracking and peeling under normal conditions. Panels with sustained exposure to corrosive environments such as chlorinated or non-potable water (irrigation systems & swimming pools), saltwater, and industrial chemicals, as well as panels that have been modified in the field (cutting, bending, etc.) are not covered.

CUSTOM FINISH

Custom panel finishes for aluminum are available for specified powders. A color matching process is not offered. All custom finishes are subject to approval by Parasoleil and are not covered by Parasoleil's standard finish warranty.

QUESTIONS?

Contact Parasoleil for complete specifications, installation requirements, and warranty coverage.

All Parasoleil patterns are protected under copyright © law. Copying, modifying, or any unauthorized use of these patterns is strictly prohibited.

Patina Finishes

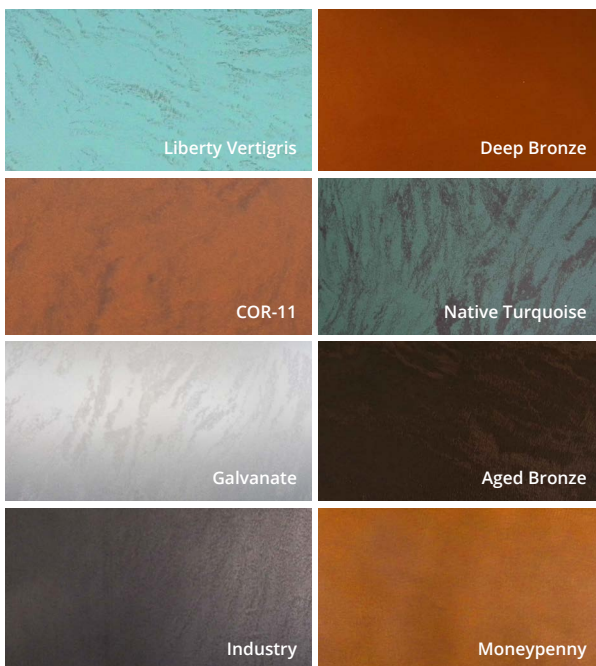

Engineering Education

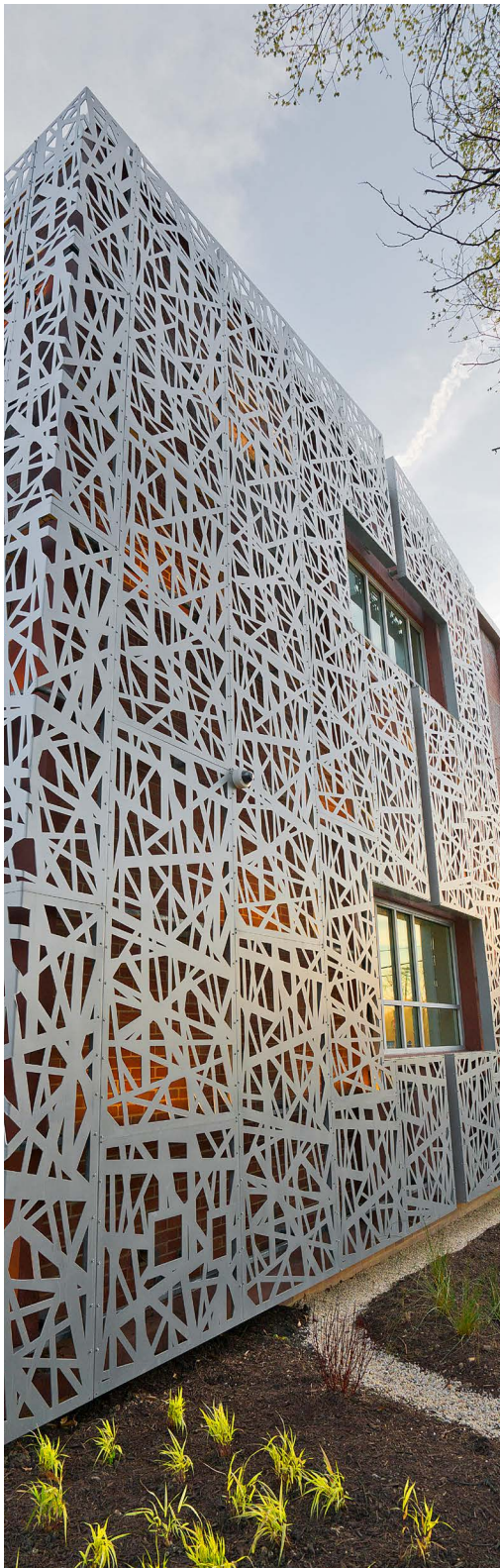

At Parasoleil, we focus on engineering standards and certifications for our products because we understand the importance of design load compliance. As a result, we have refined our approach to our panel performance in any thickness, pattern, and application.

ENGINEERING AND LOAD TESTING PROCESS

- Finite Element Analysis through computer models to understand a patterned panel's deflection
- Extensive product testing
- Code analysis
- Annual inspection for certification

WHY IT MATTERS

Panels Attached to a Building

Pre-engineered patterns ensure IAPMO-ES 0488 certification is included in the square foot price. Project-specific engineering reports can be created to provide the most accurate analysis that lowers risk and cost for the GC. If additional documentation is required, such as a California DSA or NOA for Miami-Dade county, Parasoleil can provide applied engineering reports to satisfy documentation requirements.

Panels at Ground Level Exterior

Parasoleil's pre-engineered systems prevent building department slow downs and provides instant design flexibility without requiring a change order.

Panels in Interior Applications

Though decorative panels do not require wind or snow load engineering, they should look flat, be safe, and be designed to fit together for easy installation. Parasoleil's engineered systems and dependable process ensures on-time production and expert guidance.

Engineering Education *(continued)*

PROVIDED SERVICES

Below are the following engineering services offered by Parasoleil to ensure your project, standard or custom, is fully supported by our team.

Parasoleil Engineering Services	
Panel Thickness Calibrator	✓
Product Certification (IAMPO - ES 0488)	✓
Custom Pattern FEA	✓
Panel FEA - Engineering Report	Flat Fee
PE Stamp	Flat Fee
Structure FEA - with Design Iterations	Priced Per Project

HOW PARASOLEIL CAN HELP YOU

Use Parasoleil’s expert engineering guidance or certified project reports depending on your project type.

When you engage with Parasoleil from the start, you will:

- Reduce overall cost
- Raise confidence
- Ensure you cruise through permitting
- Reduce your risk as a specifier
- Set up a smooth installation

If your project requires engineering, know that our product certification exceeds International Building Code requirements.

QUESTIONS?

Contact Parasoleil for complete specifications, installation requirements and warranty coverage.

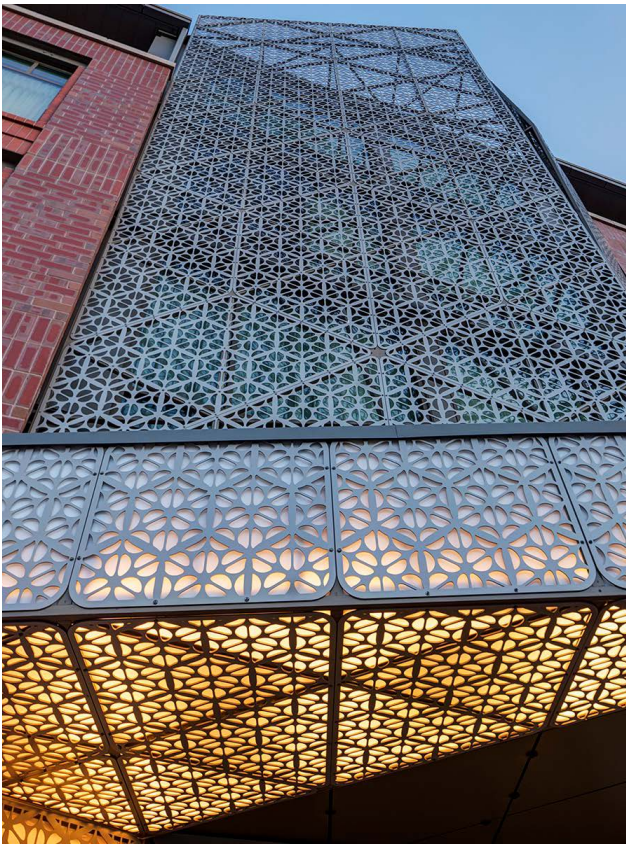



Contact Parasoleil for complete specifications, installation requirements and warranty coverage.

All Parasoleil patterns are protected under copyright law. Copying, modifying, or any unauthorized use of these patterns is strictly prohibited.

We look forward to hearing from you.

6510 W. 91st Avenue, Suite 100
Westminster, CO 80031
Phone | (303) 327-9997
Email | hello@parasoleil.com
parasoleil.com

 /ParasoleilUSA
 /Parasoleil
 /ParasoleilUSA

Parasoleil